

# MAP OF Washington and Part of Des Moines TOWNSHIP

Scale 1/4 Inches to 1 Mile

Township 79 North, Range 21 West of Fifth P. M.  
JASPER COUNTY, IOWA

Rural Routes Shown thus: Churches Shown thus: Schools Shown thus:   
 State Highways Shown thus: Cemeteries Shown thus:   
 Where Rural Routes run over the State Highways the same are denoted by Arrows. Small Property Owners are shown by a figure within a circle. A Subdivision Number is shown by a plain figure thus: 2

POWESHIEK

TOWNSHIP

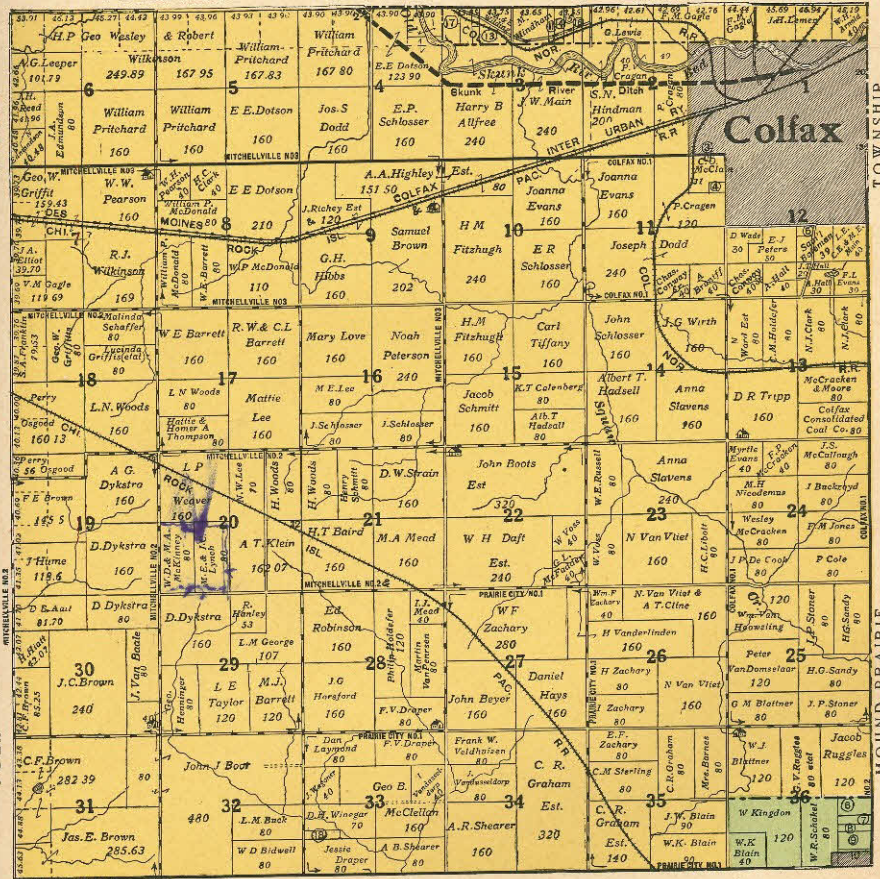

POLK CO. DES MOINES

TOWNSHIP

List of Small Property Owners in This Township Shown on Map by Numbers

| No. | Name           | Acres | Sec. | No. | Name                    | Acres | Sec. | No. | Name        | Acres | Sec. | No. | Name              | Acres | Sec. |
|-----|----------------|-------|------|-----|-------------------------|-------|------|-----|-------------|-------|------|-----|-------------------|-------|------|
| 1   | Geo. W. Bailey | 24    | 4    | 1   | J. Van Haulen & J. Voss | 20    | 10   | 10  | H. Stewart  | 10    | 2    | 15  | J. M. Richards    | 30    | 10   |
| 2   | Geo. Harding   | 10    | 11   | 2   | Gugh                    | 10    | 26   | 11  | C. Mindham  | 10    | 2    | 16  | J. M. Richards    | 10    | 10   |
| 3   | D. H. Thomas   | 11    | 11   | 3   | E. L. Adcock            | 10    | 36   | 12  | L. N. Woods | 10    | 2    | 17  | A. E. Wilding     | 10    | 10   |
| 4   | E. E. Ward     | 12    | 11   | 4   | R. L. Poucher           | 10    | 36   | 13  | J. Warrick  | 10    | 3    | 18  | C. H. Brockbridge | 10    | 10   |
| 5   |                |       |      | 5   | L. Williams             | 10    | 36   | 14  | A. Hodgson  | 10    | 3    | 19  |                   |       |      |